

- ◆ Resistive Film Load
- ◆ Finned Termination
- ◆ Power 20W
- ◆ High Peak Power
- ◆ RoHS compliant
- ◆ Designed for wireless applications



Similar product shown

Microlab TB-5MD terminations are medium power coaxial loads, which operate from DC to up to 6 GHz. Higher powers have cooling fins help to minimize temperature rise of the resistive film terminating element, contained within a carefully matched coaxial housing. Connectors are 7-16 mm DIN, male.

Part Number	Connector		Max. Power		Operating Range*, °C	VSWR		Weight oz. (g)
	Type	Frequency	Avg	Peak				
<b>TB-5MD</b>	7-16 (m)	DC - 6GHz	20W	1kW	-35° to +65°	≤1.25:1 min	DC-4.2GHz	4.23 (120)
						<1.25:1 typ. ≤1.35:1 min	4.2-6.0GHz	

\* Derate -1.5% per °C above +50°C\*

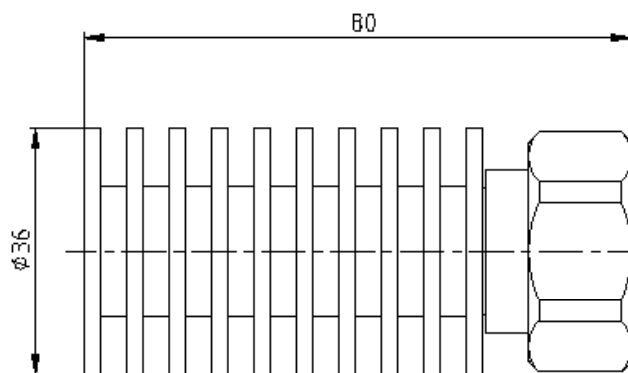

Note: Specifications are subject to change without prior notification.

26NOV2024